



MOVE-IN READY FOR LEASE – MEDICAL OFFICE SUITE

273 W Church Street
Lewisville, TX

LOCATION

Move-in ready medical office space for lease in single-story building located adjacent to Historic Old Town Lewisville.

Under one mile to Medical City Lewisville. The location has easy access to I-35 E, TX-121 and all nearby retail and restaurant offerings. Walking distance to Lewisville City Hall.

SPACES AVAILABLE

LAST SPACE AVAILABLE

- Suite 200 – 1,520 RSF

LEASE RATE

- Base Rent \$15.00/SF/YR + NNNS

HIGHLIGHTS

- Move-in Ready
- Fully Finished Out Medical Office
- Three Exam Rooms with Sinks
- Spacious Waiting Area
- Private Entrance
- Separate Patient and Staff Restrooms

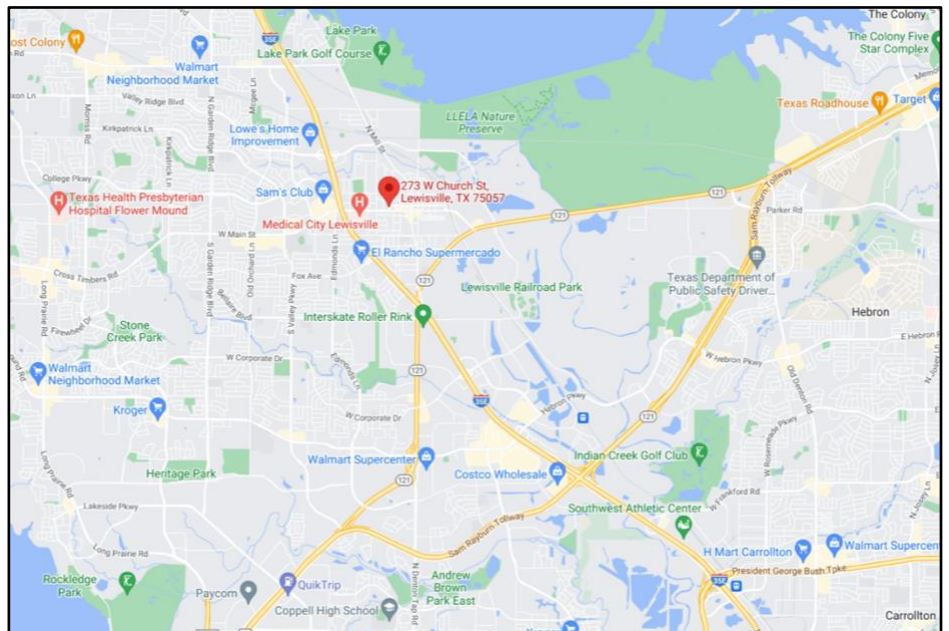

FOR INFORMATION:

Diana Pergande: Diana@BridgeRealtyTexas.com

Phyllis Garcia: Phyllis@BridgeRealtyTexas.com

www.BridgeRealtyTexas.com | 972.899.1851

400 Parker Square, Suite 270H | Flower Mound, TX 75028

This information is believed to be accurate, but no representation or warranty, express or implied, as to its accuracy or completeness is made by any party. The presentation of this property is submitted subject to errors, omissions, change of price or prior sale or lease, or withdrawal without notice.



BUILDING SITE

273 W Church Street
Lewisville, TX

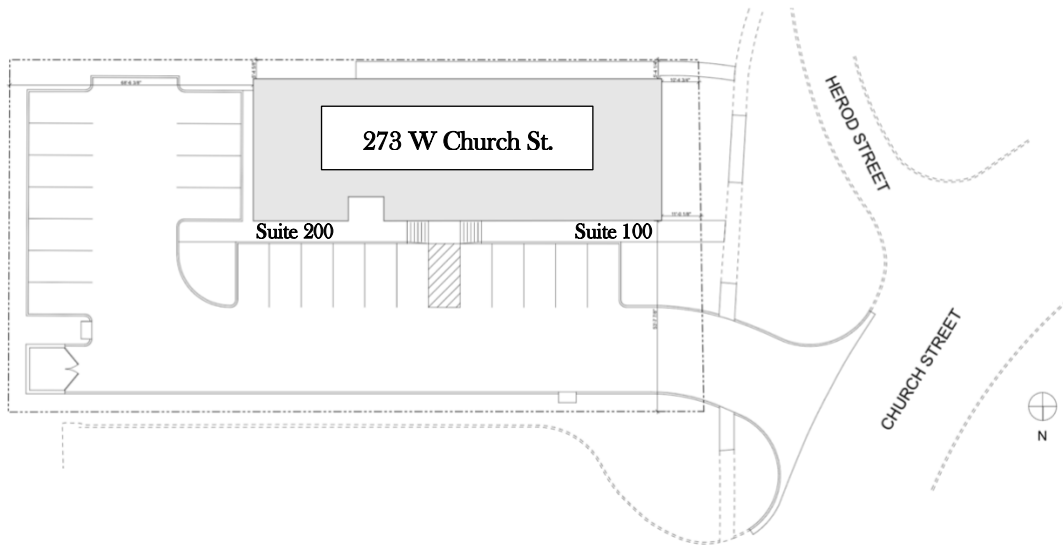

1 SITE PLAN





FLOOR PLAN

273 W Church Street, Suite 200
Lewisville, TX

273 W Church St, Suite 200 Lewisville, TX 75057

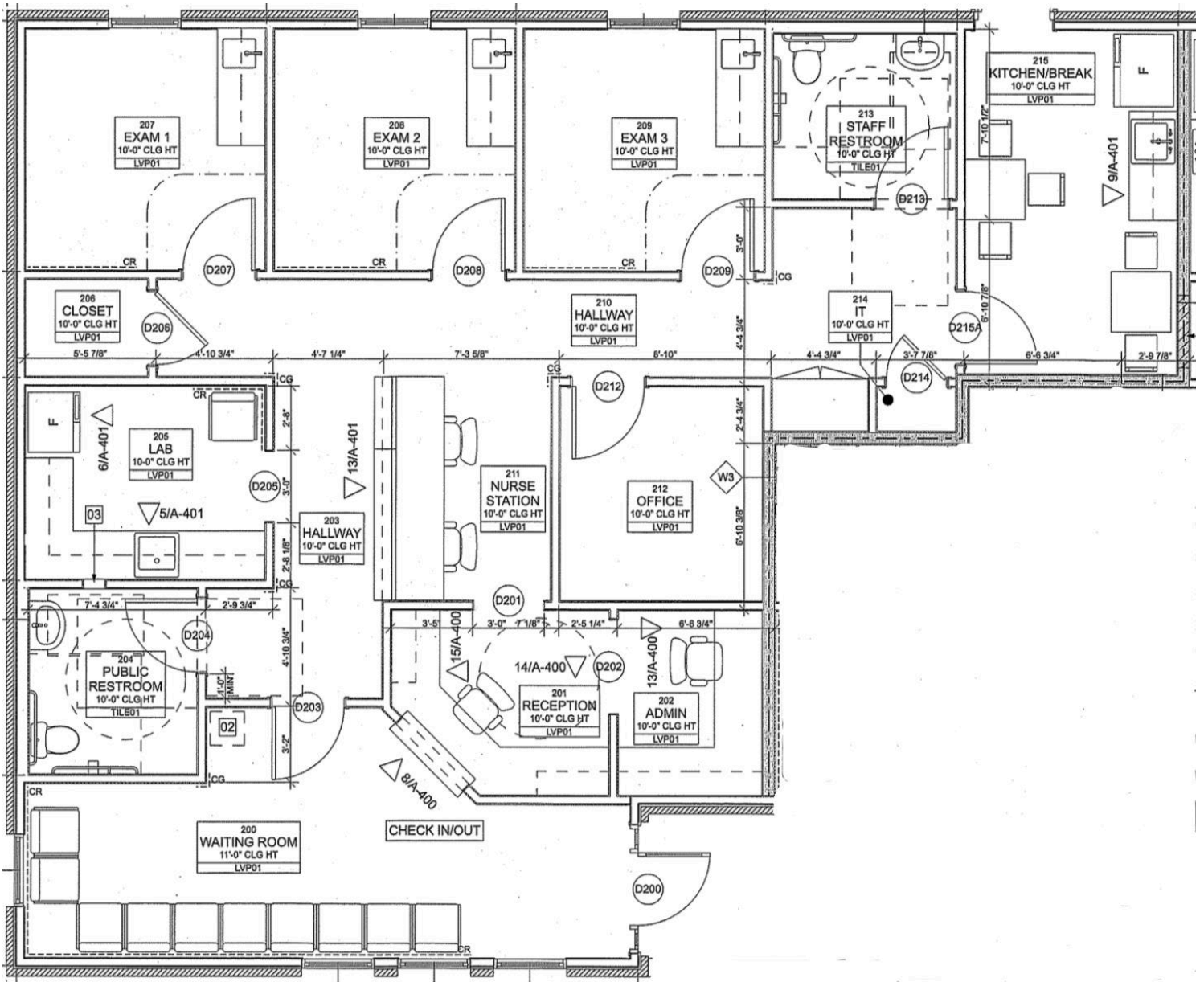



BRIDGE REALTY
of
TEXAS
COMMERCIAL REAL ESTATE

PHOTOS

273 W Church Street, Suite 200
Lewisville, TX

